

NOTICE: These documents are instruments of professional service and information contained herein is in conjunction with Lantz-Boggio's interpretations, decisions, observations and administrations. Use or reproduction of these documents in whole or part without Lantz-Boggio's consent is a violation of common law, copyright, statutory and other reserved rights. Refer to Act 17 U.S.C., par. 301 (1991), which prohibits state and local public records act. Refer to Act 17 U.S.C., par. 511 (1991), which prohibits state and local public records act.

Owner:
 Campbell County Memorial Hospital
 501 South Burma Ave.
 Gillette, WY 82716
 P.O. Box 3011
 Gillette, WY 82717
 Ph. 307.688.1000

Civil Engineer:
 PCA Engineering, Inc.
 P.O. Box 2185
 4506 Wigwam Blvd.
 Gillette, WY 82718
 Ph. 307.687.0600
 Contact: Clark Sanders

Structural Engineer:
 Jirsa Hedrick & Associates
 7000 E. Bellevue Ave. Suite 250
 Greenwood Village, CO 80111
 Ph. 303.839.1963
 Contact: Steve Jirsa

Mechanical/Plumbing Engineer:
 Given & Associates, Inc.
 735 S. Xenon Court, Suite 201
 Lakewood, CO 80228
 Contact: Jeff Given

Electrical Engineer:
 Alber Engineering
 5173 Oak Hollow Drive
 Morrison, CO 80465
 Ph. 303.736.2739
 Contact: Jerry Alber

FLOOR PLAN GENERAL NOTES:

- 1. ALL PARTITION WALLS AND EXTERIOR WALLS ARE DIMENSIONED STUD TO STUD UNLESS NOTED OTHERWISE.
- 2. REFER TO SHEET A-600 FOR CONSTRUCTION OF WALL ASSEMBLIES.
- 3. ALL EXTERIOR WALLS TO BE WT501 & WT502 UNLESS OTHERWISE NOTED.
- 4. ALL GYPSUM BOARD ADJACENT TO SHOWERS & TUBS IS TO BE MOISTURE/ MOLD RESISTANT (FIBERGLASS AQUA-TOUGH INTERIOR PANELS OR APPROVED EQUAL). COORDINATE WITH ASSEMBLY TYPE WITH REGARDS TO FIRE RATING.
- 5. GRIDLINES FALL ON FACE OF STUD, TYP.
- 6. REFER TO A-900 SERIES FOR DOOR SCHEDULE.
- 7. REFER TO A-900 SERIES FOR WINDOW SCHEDULE.
- 8. REFER TO INTERIOR WALL AND FLOOR FINISH PLANS FOR FINISH INFORMATION.
- 9. INTERIOR DOORS TO BE FRAMED 4" FROM ADJACENT WALL TYP., U.O.N.
- 10. PROVIDE BLOCKING AT ALL EXTERIOR WINDOWS FOR INSTALLATION OF WINDOW COVERINGS. BLOCKING TO BE MINIMUM 4"x4" AT UPPER CORNERS OF GYPSUM BOARD OPENINGS FOR WINDOWS. LOCATED ABOVE AND TO THE OUTSIDE OF THE OPENINGS.
- 11. CHAIRRAIL, RE: INTERIOR WALL FINISH PLAN FOR LOCATIONS.
- 12. CORRIDOR HANDRAIL RE: INTERIOR WALL FINISH PLAN FOR LOCATIONS.
- 13. SEE SHEETS A-530 FOR ADDITIONAL DIMENSIONS FOR THE ELEVATOR SHAFT AND OPENING SIZES.
- 14. REFER TO SHEET A-250 FOR ROOF PLAN.
- 15. REFER TO FOOD SERVICE DRAWINGS FOR KITCHEN EQUIPMENT LIST, ETC.
- 16. SEE SHEETS A-230 FOR ENLARGED RESIDENT UNITS AND RESIDENT BATHROOM FLOOR PLANS.
- 17. DETAILS FOR HANDRAIL TRANSITIONS RE: SHEET A-851.
- 18. ALL DIMENSIONS ARE TO CENTERLINE OF WINDOW & DOORS UNLESS NOTED OTHERWISE.

FLOOR PLAN KEY NOTES:

- 1 FURR-OUT EXTERIOR WALL WITH EXTRA LAYER OF GYP BD. TO ALIGN WITH INTERIOR WALL.
- 2 REFER TO SHEETS A-230 FOR ENLARGED RESIDENT ROOM & RESIDENT BATHROOM PLANS.
- 3 GAS FIREPLACE, RE: SPECIFICATIONS.
- 4 WASHING MACHINE, RE: SPECIFICATIONS.
- 5 DRYER, RE: SPECIFICATIONS.
- 6 ADDITIONAL FURRED OUT WALL AT PLUMBING WALL EXTERIOR.
- 7 SHELVING, RE: SI A-851.
- 8 REFER TO ENLARGED TOILET PLAN FOR ALL TOILET ACCESSORIES.
- 9 NOT USED.
- 10 ELEVATOR: RE SPECIFICATIONS.
- 11 PLASTIC LAMINATE COUNTER WITH SINK AND CABINETRY.
- 12 STAFF LOCKERS: RE: SPECIFICATIONS.
- 13 PLASTIC LAMINATE COMPUTER WORKSTATION, RE: INTERIOR ELEVATION.
- 14 ELECTRIC WATER COOLERS: RE: PLUMBING.
- 15 CUSTOM BUILT-IN CASEWORK; RE: INTERIOR DESIGN DRAWINGS.
- 16 PLASTIC LAMINATE COUNTER; RE: INTERIOR ELEVATIONS.
- 17 MOP SINK REFER TO TYPICAL ELEVATIONS 25 & 26/ A-800; RE: PLUMBING.
- 18 OUTLINE OF ROOF BELOW.
- 19 REFRIGERATOR, RE: SPECIFICATIONS.
- 20 PARTIAL HEIGHT WALL, RE: INTERIOR ELEVATION.
- 21 MEDICATION DISPENSER, BY OWNER.
- 22 ROOF HATCH LADDER RE: SPECIFICATIONS.
- 23 ADJUSTABLE SINK; RE: PLUMBING.
- 24 UNDER-COUNTER REFRIGERATOR; RE: SPECIFICATIONS.
- 25 BASEBOARD HEAT; RE: MECHANICAL.
- 26 ALIGN WALLS.
- 27 KITCHEN/ SERVERY EQUIPMENT, RE: FOOD SERVICE PLANS.
- 28 FLUSH SINK; RE: PLUMBING.
- 29 TIMECLOCK, BY OWNER.
- 30 COUNTER TOP WITH UNDERMOUNT SINK; RE: INTERIOR FINISH SPECIFICATIONS.
- 31 ROOF/ DECK DRAIN.
- 32 FURR OUT ALL CONCRETE PILASTERS WITH WT514.
- 33 FURR OUT ENTIRE ROOM WITH WT514 AS SHOWN.
- 34 DOCK LEVELER, RE: SPECIFICATIONS.
- 35 ADDITIONAL FURR OUT AT STOREFRONT WINDOWS, WT514 AS SHOWN.
- 36 FOLDING DOORS; RE: SPECIFICATIONS.
- 37 EXTERIOR RAILING, RE: SPECIFICATIONS.
- 38 ROOF ABOVE.

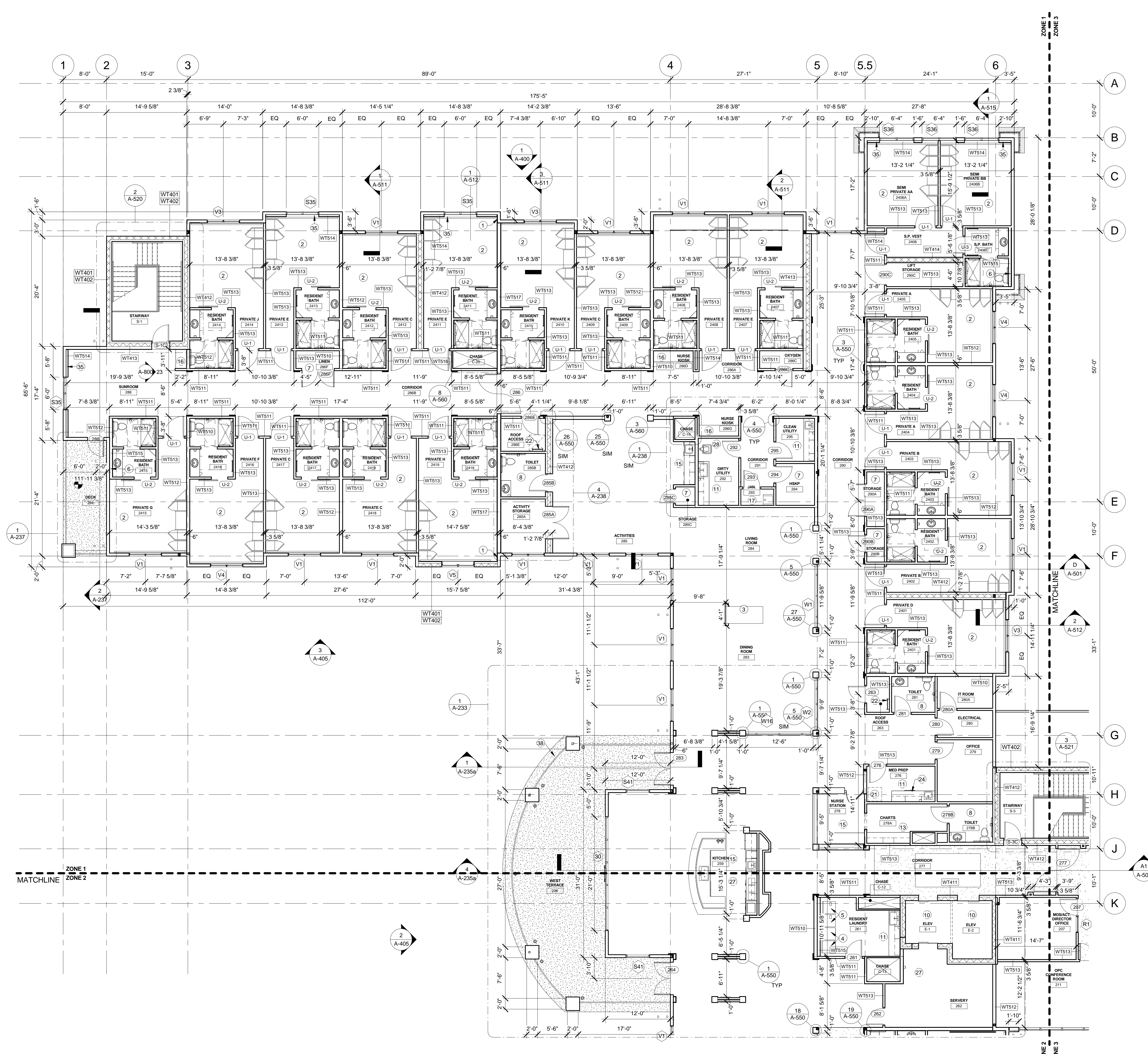

No.	Date	Description
1	06/17/2013	Design Development
2	10/31/2013	Construction Documents

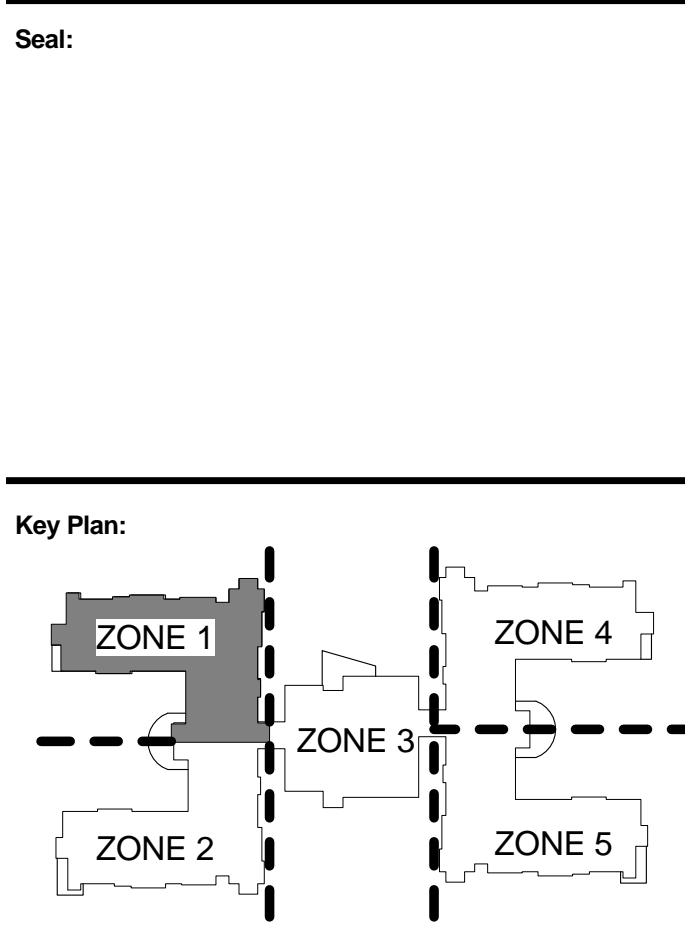

1 SECOND FLOOR PLAN - ZONE 1
 SCALE: 1/8" = 1'-0"

SECOND FLOOR PLAN - ZONE 1